

COMBICON Plugs and Headers as a „high current“ (HC) Version for Currents up to 16 A, 5.0 or 5.08 mm Pitch

Tuning for the MSTB classic

The proven COMBICON MSTB plug connector is now available as a "high current" (HC) version for currents up to 16 A. On top of the familiar MSTB features, a double steel spring guarantees extra safety for higher power transmission.

The HC family is available with 2 to 12 positions and in pitches of 5.0 and 5.08 mm.

Only the MSTB 2,5 HC headers provided are allowed to be used for carrying the higher current load of 16 A.

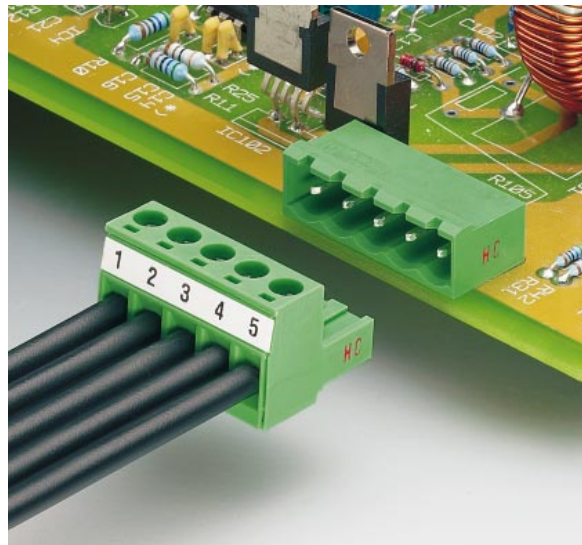

MSTB 2,5 HC/...-ST(-5,08) 5.0 or 5.08 mm Pitch

The designation "HC" is printed in red to provide clear identification of "high current" plugs and headers.

Only the MSTB 2,5 HC headers provided are allowed to be used for carrying the higher current load of 16 A.



Note:

Only actuate COMBICON plug connectors when under no load condition. If for operating reasons small loads must be switched, experimental values are available upon request.

| Description | No. of pos. | Dim. a [mm] | Type | Order No. | Pcs./Pkt. |
|---|-------------|---|--|------------|-----------|
| COMBICON HC plugs, 5.0 mm pitch | | | | | |
| color: green | 2 | 5 | MSTB 2,5 HC/2-ST | 19 11 85 5 | 50 |
| | 3 | 10 | MSTB 2,5 HC/3-ST | 19 11 86 8 | |
| | 4 | 15 | MSTB 2,5 HC/4-ST | 19 11 87 1 | |
| | 5 | 20 | MSTB 2,5 HC/5-ST | 19 11 88 4 | |
| | 6 | 25 | MSTB 2,5 HC/6-ST | 19 11 89 7 | |
| | 7 | 30 | MSTB 2,5 HC/7-ST | 19 11 90 7 | |
| | 8 | 35 | MSTB 2,5 HC/8-ST | 19 11 91 0 | |
| | 9 | 40 | MSTB 2,5 HC/9-ST | 19 11 92 3 | |
| | 10 | 45 | MSTB 2,5 HC/10-ST | 19 11 93 6 | |
| | 11 | 50 | MSTB 2,5 HC/11-ST | 19 11 94 9 | |
| | 12 | 55 | MSTB 2,5 HC/12-ST | 19 11 95 2 | |
| COMBICON HC plugs, 5.08 mm pitch | | | | | |
| color: green | 2 | 5.08 | MSTB 2,5 HC/2-ST-5,08 | 19 11 96 5 | 50 |
| | 3 | 10.16 | MSTB 2,5 HC/3-ST-5,08 | 19 11 97 8 | |
| | 4 | 15.24 | MSTB 2,5 HC/4-ST-5,08 | 19 11 98 1 | |
| | 5 | 20.32 | MSTB 2,5 HC/5-ST-5,08 | 19 11 99 4 | |
| | 6 | 25.40 | MSTB 2,5 HC/6-ST-5,08 | 19 12 00 3 | |
| | 7 | 30.48 | MSTB 2,5 HC/7-ST-5,08 | 19 12 01 6 | |
| | 8 | 35.56 | MSTB 2,5 HC/8-ST-5,08 | 19 12 02 9 | |
| | 9 | 40.64 | MSTB 2,5 HC/9-ST-5,08 | 19 12 03 2 | |
| | 10 | 45.72 | MSTB 2,5 HC/10-ST-5,08 | 19 12 04 5 | |
| | 11 | 50.80 | MSTB 2,5 HC/11-ST-5,08 | 19 12 05 8 | |
| | 12 | 55.88 | MSTB 2,5 HC/12-ST-5,08 | 19 12 06 1 | |
| (1) Coding profile, is inserted into the groove on the plug, red insulating material | |  | CP-MSTB | 17 34 63 4 | |
| (2) Marker card, with 12 pcs. 10-section marker strips, white, self-adhesive, for 120 terminal blocks | | | SK 5/3,8 or SK 5,08/3,8 (see COMBICON catalog) | | |

Technical data

| | | | |
|---|---|---------------------------------|----------------|
| Dimensions | see description on page 13 | | |
| Pitch | [mm] | 5 / 5.08 | |
| Hole diameter | [mm] | - | |
| Pin dimensions | [mm]x[mm] | - | |
| Technical data in accordance with IEC/ DIN VDE | | | |
| Insulating material group | - | I | |
| Surge voltage category / contamination class | -/- | III / 3 | III / 2 II / 2 |
| Rated voltage | [V] | 250 | 320 630 |
| Rated surge voltage | [kV] | 4 | 4 4 |
| Nominal current / cross section | [A]/[mm ²] | 16 / 2.5 | |
| Maximum load current / cross section | [A]/[mm ²] | 16 / 2.5 | |
| Capacity connection | | | |
| Solid / stranded / conductor sizes | [mm ²]/[mm ²]/AWG | 0.2 - 2.5 / 0.2 - 2.5 / 24 - 12 | |
| Stranded with ferrule without / with plastic sleeve | [mm ²] | 0.25 - 2.5 / 0.25 - 2.5 | |
| Multiple connection (2 conductors with same cross section) | | | |
| Solid / stranded | [mm ²] | 0.2 - 1 / 0.2 - 1.5 | |
| Stranded with ferrule with plastic sleeve | [mm ²] | 0.25 - 1 | |
| Stranded with TWIN ferrule with plastic sleeve | [mm ²] | 0.5 - 1.5 | |
| Stripping length | [mm] | 7 | |
| Internal cylindrical gauge (IEC 60 947-1) | | A 3 | |
| Thread | | M 3 | |
| Torque | [Nm] | 0.5 - 0.6 | |
| Insulating material | | PA | |
| Inflammability class in acc. with UL 94 | | V0 | |

MSTB 2,5 HC/...-STF(-5,08) with Srew Flange 5.0 or 5.08 mm Pitch

The designation "HC" is printed in red to provide clear identification of "high current" plugs and headers.

Only the MSTB 2,5 HC headers provided are allowed to be used for carrying the higher current load of 16 A.



Note:

Only actuate COMBICON plug connectors when under no load condition. If for operating reasons small loads must be switched, experimental values are available upon request.

| Description | No. of pos. | Dim. a [mm] | Type | Order No. | Pcs./Pkt. |
|---|--|-------------|---|-------------------------------|-------------------|
| COMBICON HC plugs, 5.0 mm pitch, with screw flange, color: green | 2 | 5 | MSTB 2,5 HC/2-STF | 19 12 07 4 | 50 |
| | 3 | 10 | MSTB 2,5 HC/3-STF | 19 12 08 7 | |
| | 4 | 15 | MSTB 2,5 HC/4-STF | 19 12 09 0 | |
| | 5 | 20 | MSTB 2,5 HC/5-STF | 19 12 10 0 | |
| | 6 | 25 | MSTB 2,5 HC/6-STF | 19 12 11 3 | |
| | 7 | 30 | MSTB 2,5 HC/7-STF | 19 12 12 6 | |
| | 8 | 35 | MSTB 2,5 HC/8-STF | 19 12 13 9 | |
| | 9 | 40 | MSTB 2,5 HC/9-STF | 19 12 14 2 | |
| | 10 | 45 | MSTB 2,5 HC/10-STF | 19 12 15 5 | |
| | 11 | 50 | MSTB 2,5 HC/11-STF | 19 12 16 8 | |
| | 12 | 55 | MSTB 2,5 HC/12-STF | 19 12 17 1 | |
| | COMBICON HC plugs, 5.08 mm pitch, with screw flange, color: green | 2 | 5.08 | MSTB 2,5 HC/2-STF-5,08 | |
| 3 | | 10.16 | MSTB 2,5 HC/3-STF-5,08 | 19 12 19 7 | |
| 4 | | 15.24 | MSTB 2,5 HC/4-STF-5,08 | 19 12 20 7 | |
| 5 | | 20.32 | MSTB 2,5 HC/5-STF-5,08 | 19 12 21 0 | |
| 6 | | 25.40 | MSTB 2,5 HC/6-STF-5,08 | 19 12 22 3 | |
| 7 | | 30.48 | MSTB 2,5 HC/7-STF-5,08 | 19 12 23 6 | |
| 8 | | 35.56 | MSTB 2,5 HC/8-STF-5,08 | 19 12 24 9 | |
| 9 | | 40.64 | MSTB 2,5 HC/9-STF-5,08 | 19 12 25 2 | |
| 10 | | 45.72 | MSTB 2,5 HC/10-STF-5,08 | 19 12 26 5 | |
| 11 | | 50.80 | MSTB 2,5 HC/11-STF-5,08 | 19 12 27 8 | |
| 12 | | 55.88 | MSTB 2,5 HC/12-STF-5,08 | 19 12 28 1 | |
| (1) Coding profile , is inserted into the groove on the plug, red insulating material | | |  | CP-MSTB | 17 34 63 4 |
| (2) Marker card , with 12 pcs. 10-section marker strips, white, self-adhesive, for 120 terminal blocks | | | SK 5/3,8 or SK 5,08/3,8 (see COMBICON catalog) | | |

Technical data

| | | | |
|---|----------------------------|---------------------------------|-------------------|
| Dimensions | see description on page 13 | | |
| Pitch | [mm] | 5 / 5.08 | |
| Hole diameter | [mm] | - | |
| Pin dimensions | [mm]x[mm] | - | |
| Technical data in accordance with IEC/ DIN VDE | | | |
| Insulating material group | - | I | |
| Surge voltage category / contamination class | -/- | III / 3 | III / 2 II / 2 |
| Rated voltage | [V] | 250 | 320 630 |
| Rated surge voltage | [kV] | 4 | 4 4 |
| Nominal current / cross section | [A]/[mm²] | | 16 / 2.5 |
| Maximum load current / cross section | [A]/[mm²] | | 16 / 2.5 |
| Capacity connection | | | |
| Solid / stranded / conductor sizes | [mm²]/[mm²]/AWG | 0.2 - 2.5 / 0.2 - 2.5 / 24 - 12 | |
| Stranded with ferrule without / with plastic sleeve | [mm²] | 0.25 - 2.5 / 0.25 - 2.5 | |
| Multiple connection (2 conductors with same cross section) | | | |
| Solid / stranded | [mm²] | 0.2 - 1 / 0.2 - 1.5 | |
| Stranded with ferrule with plastic sleeve | [mm²] | 0.25 - 1 | |
| Stranded with TWIN ferrule with plastic sleeve | [mm²] | 0.5 - 1.5 | |
| Stripping length | [mm] | 7 | |
| Internal cylindrical gauge (IEC 60 947-1) | | A 3 | |
| Thread | | M 3 | |
| Torque | [Nm] | 0.5 - 0.6 | |
| Insulating material | | PA | |
| Inflammability class in acc. with UL 94 | | V0 | |

MSTBT 2,5 HC/...-ST

5.0 mm Pitch

The designation "HC" is printed in red to provide clear identification of "high current" plugs and headers.

Only the MSTB 2,5 HC headers provided are allowed to be used for carrying the higher current load of 16 A.



Note:

Only actuate COMBICON plug connectors when under no load condition. If for operating reasons small loads must be switched, experimental values are available upon request.

| Description | No. of pos. | Dim. a [mm] | Type | Order No. | Pcs./Pkt. |
|---|-------------|---|---|-------------------|-----------|
| COMBICON HC plugs, 5.0 mm pitch, color: green | 2 | 5 | MSTBT 2,5 HC/2-ST | 19 26 35 8 | 50 |
| | 3 | 10 | MSTBT 2,5 HC/3-ST | 19 26 24 8 | |
| | 4 | 15 | MSTBT 2,5 HC/4-ST | 19 26 25 1 | |
| | 5 | 20 | MSTBT 2,5 HC/5-ST | 19 26 26 4 | |
| | 6 | 25 | MSTBT 2,5 HC/6-ST | 19 26 27 7 | |
| | 7 | 30 | MSTBT 2,5 HC/7-ST | 19 26 28 0 | |
| | 8 | 35 | MSTBT 2,5 HC/8-ST | 19 26 29 3 | |
| | 9 | 40 | MSTBT 2,5 HC/9-ST | 19 26 30 3 | |
| | 10 | 45 | MSTBT 2,5 HC/10-ST | 19 26 31 6 | |
| | 11 | 50 | MSTBT 2,5 HC/11-ST | 19 26 32 9 | |
| | 12 | 55 | MSTBT 2,5 HC/12-ST | 19 26 33 2 | |
| (1) Coding profile , is inserted into the groove on the plug, red insulating material | |  | CP-MSTB | 17 34 63 4 | |
| (2) Marker card , with 12 pcs. 10-section marker strips, white, self-adhesive, for 120 terminal blocks | | | SK 5/3,8 (see COMBICON catalog) | | |

Technical data

| | | | | |
|---|---|---------------------------------|---------|--------|
| Dimensions | | see description on page 13 | | |
| Pitch | [mm] | 5 | | |
| Hole diameter | [mm] | - | | |
| Pin dimensions | [mm]x[mm] | - | | |
| Technical data in accordance with IEC/ DIN VDE | | | | |
| Insulating material group | - | I | | |
| Surge voltage category / contamination class | -/- | III / 3 | III / 2 | II / 2 |
| Rated voltage | [V] | 250 | 320 | 630 |
| Rated surge voltage | [kV] | 4 | 4 | 4 |
| Nominal current / cross section | [A]/[mm ²] | 16 / 2.5 | | |
| Maximum load current / cross section | [A]/[mm ²] | 16 / 2.5 | | |
| Capacity connection | | | | |
| Solid / stranded / conductor sizes | [mm ²]/[mm ²]/AWG | 0.2 - 2.5 / 0.2 - 2.5 / 24 - 12 | | |
| Stranded with ferrule without / with plastic sleeve | [mm ²] | 0.25 - 2.5 / 0.25 - 2.5 | | |
| Multiple connection (2 conductors with same cross section) | | | | |
| Solid / stranded | [mm ²] | 0.2 - 1 / 0.2 - 1.5 | | |
| Stranded with ferrule with plastic sleeve | [mm ²] | 0.25 - 1 | | |
| Stranded with TWIN ferrule with plastic sleeve | [mm ²] | 0.5 - 1.5 | | |
| Stripping length | [mm] | 7 | | |
| Internal cylindrical gauge (IEC 60 947-1) | | A 3 | | |
| Thread | | M 3 | | |
| Torque | [Nm] | 0.5 - 0.6 | | |
| Insulating material | | PA | | |
| Inflammability class in acc. with UL 94 | | V0 | | |

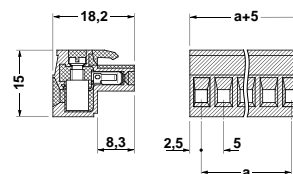

MVSTBR 2,5 HC/...-ST(-5,08)

Vertical Plugs

5.0 or 5.08 mm Pitch

The designation "HC" is printed in red to provide clear identification of "high current" plugs and headers.

Only the MSTB 2,5 HC headers provided are allowed to be used for carrying the higher current load of 16 A.



Note:

Only actuate COMBICON plug connectors when under no load condition. If for operating reasons small loads must be switched, experimental values are available upon request.

| Description | No. of pos. | Dim. a [mm] | Type | Order No. | Pcs./Pkt. |
|--|---|-------------|---|-------------------------|------------|
| COMBICON HC plugs, 5.0 mm pitch, plug-in direction vertical to the conductor axis, connection point facing the smooth wall (R) of the header, color: green | 2 | 5 | MVSTBR 2,5 HC/2-ST | 19 12 29 4 | 50 |
| | 3 | 10 | MVSTBR 2,5 HC/3-ST | 19 12 30 4 | |
| | 4 | 15 | MVSTBR 2,5 HC/4-ST | 19 12 31 7 | |
| | 5 | 20 | MVSTBR 2,5 HC/5-ST | 19 12 32 0 | |
| | 6 | 25 | MVSTBR 2,5 HC/6-ST | 19 12 33 3 | |
| | 7 | 30 | MVSTBR 2,5 HC/7-ST | 19 12 34 6 | |
| | 8 | 35 | MVSTBR 2,5 HC/8-ST | 19 12 35 9 | |
| | 9 | 40 | MVSTBR 2,5 HC/9-ST | 19 12 36 2 | |
| | 10 | 45 | MVSTBR 2,5 HC/10-ST | 19 12 37 5 | |
| | 11 | 50 | MVSTBR 2,5 HC/11-ST | 19 12 38 8 | |
| | 12 | 55 | MVSTBR 2,5 HC/12-ST | 19 12 39 1 | |
| | COMBICON HC plugs, 5.08 mm pitch, plug-in direction vertical to the conductor axis, connection point facing the smooth wall (R) of the header, color: green | 2 | 5.08 | MVSTBR 2,5 HC/2-ST-5,08 | |
| 3 | | 10.16 | MVSTBR 2,5 HC/3-ST-5,08 | 19 12 41 4 | |
| 4 | | 15.24 | MVSTBR 2,5 HC/4-ST-5,08 | 19 12 42 7 | |
| 5 | | 20.32 | MVSTBR 2,5 HC/5-ST-5,08 | 19 12 43 0 | |
| 6 | | 25.40 | MVSTBR 2,5 HC/6-ST-5,08 | 19 12 44 3 | |
| 7 | | 30.48 | MVSTBR 2,5 HC/7-ST-5,08 | 19 12 45 6 | |
| 8 | | 35.56 | MVSTBR 2,5 HC/8-ST-5,08 | 19 12 46 9 | |
| 9 | | 40.64 | MVSTBR 2,5 HC/9-ST-5,08 | 19 12 47 2 | |
| 10 | | 45.72 | MVSTBR 2,5 HC/10-ST-5,08 | 19 12 48 5 | |
| 11 | | 50.80 | MVSTBR 2,5 HC/11-ST-5,08 | 19 12 49 8 | |
| 12 | | 55.88 | MVSTBR 2,5 HC/12-ST-5,08 | 19 12 50 8 | |
| (1) Coding profile , is inserted into the groove on the plug, red insulating material | | |  | CP-MSTB | 17 34 63 4 |
| (2) Marker card , with 12 pcs. 10-section marker strips, white, self-adhesive, for 120 terminal blocks | | | SK 5/3,8 or SK 5,08/3,8 (see COMBICON catalog) | | |

Technical data

| | | | |
|---|---|---------------------------------|---------|
| Dimensions | see description on page 13 | | |
| Pitch | [mm] | 5 / 5.08 | |
| Hole diameter | [mm] | - | |
| Pin dimensions | [mm]x[mm] | - | |
| Technical data in accordance with IEC/ DIN VDE | | | |
| Insulating material group | - | I | |
| Surge voltage category / contamination class | -/- | III / 3 | III / 2 |
| Rated voltage | [V] | 250 | 320 |
| Rated surge voltage | [kV] | 4 | 4 |
| Nominal current / cross section | [A]/[mm ²] | 16 / 2.5 | |
| Maximum load current / cross section | [A]/[mm ²] | 16 / 2.5 | |
| Capacity connection | | | |
| Solid / stranded / conductor sizes | [mm ²]/[mm ²]/AWG | 0.2 - 2.5 / 0.2 - 2.5 / 24 - 12 | |
| Stranded with ferrule without / with plastic sleeve | [mm ²] | 0.25 - 2.5 / 0.25 - 2.5 | |
| Multiple connection (2 conductors with same cross section) | | | |
| Solid / stranded | [mm ²] | 0.2 - 1 / 0.2 - 1.5 | |
| Stranded with ferrule with plastic sleeve | [mm ²] | 0.25 - 1 | |
| Stranded with TWIN ferrule with plastic sleeve | [mm ²] | 0.5 - 1.5 | |
| Stripping length | [mm] | 7 | |
| Internal cylindrical gauge (IEC 60 947-1) | | A 3 | |
| Thread | | M 3 | |
| Torque | [Nm] | 0.5 - 0.6 | |
| Insulating material | | PA | |
| Inflammability class in acc. with UL 94 | | V0 | |

MVSTBR 2,5 HC/...-STF(-5,08) Vertical Plugs with Screw Flange 5.0 or 5.08 mm Pitch

The designation "HC" is printed in red to provide clear identification of "high current" plugs and headers.

Only the MSTB 2,5 HC headers provided are allowed to be used for carrying the higher current load of 16 A.



Note:

Only actuate COMBICON plug connectors when under no load condition. If for operating reasons small loads must be switched, experimental values are available upon request.

| Description | No. of pos. | Dim. a [mm] | Type | Order No. | Pcs./Pkt. |
|---|--|-------------|---|--------------------------|------------|
| COMBICON HC plugs, 5.0 mm pitch, with screw flange, color: green, connection point facing the smooth wall (R) of the header | 2 | 5 | MVSTBR 2,5 HC/2-STF | 19 12 51 1 | 50 |
| | 3 | 10 | MVSTBR 2,5 HC/3-STF | 19 12 52 4 | |
| | 4 | 15 | MVSTBR 2,5 HC/4-STF | 19 12 53 7 | |
| | 5 | 20 | MVSTBR 2,5 HC/5-STF | 19 12 54 0 | |
| | 6 | 25 | MVSTBR 2,5 HC/6-STF | 19 12 55 3 | |
| | 7 | 30 | MVSTBR 2,5 HC/7-STF | 19 12 56 6 | |
| | 8 | 35 | MVSTBR 2,5 HC/8-STF | 19 12 57 9 | |
| | 9 | 40 | MVSTBR 2,5 HC/9-STF | 19 12 58 2 | |
| | 10 | 45 | MVSTBR 2,5 HC/10-STF | 19 12 59 5 | |
| | 11 | 50 | MVSTBR 2,5 HC/11-STF | 19 12 60 5 | |
| | 12 | 55 | MVSTBR 2,5 HC/12-STF | 19 12 61 8 | |
| | COMBICON HC plugs, 5.08 mm pitch, with screw flange, color: green, connection point facing the smooth wall (R) of the header | 2 | 5.08 | MVSTBR 2,5 HC/2-STF-5,08 | |
| 3 | | 10.16 | MVSTBR 2,5 HC/3-STF-5,08 | 19 12 63 4 | |
| 4 | | 15.24 | MVSTBR 2,5 HC/4-STF-5,08 | 19 12 64 7 | |
| 5 | | 20.32 | MVSTBR 2,5 HC/5-STF-5,08 | 19 12 65 0 | |
| 6 | | 25.40 | MVSTBR 2,5 HC/6-STF-5,08 | 19 12 66 3 | |
| 7 | | 30.48 | MVSTBR 2,5 HC/7-STF-5,08 | 19 12 67 6 | |
| 8 | | 35.56 | MVSTBR 2,5 HC/8-STF-5,08 | 19 12 68 9 | |
| 9 | | 40.64 | MVSTBR 2,5 HC/9-STF-5,08 | 19 12 69 2 | |
| 10 | | 45.72 | MVSTBR 2,5 HC/10-STF-5,08 | 19 12 70 2 | |
| 11 | | 50.80 | MVSTBR 2,5 HC/11-STF-5,08 | 19 12 71 5 | |
| 12 | | 55.88 | MVSTBR 2,5 HC/12-STF-5,08 | 19 12 72 8 | |
| (1) Coding profile , is inserted into the groove on the plug, red insulating material | | |  | CP-MSTB | 17 34 63 4 |
| (2) Marker card , with 12 pcs. 10-section marker strips, white, self-adhesive, for 120 terminal blocks | | | SK 5/3,8 or SK 5,08/3,8 (see COMBICON catalog) | | |

Technical data

| | | | | |
|---|-----------------|---------------------------------|---------|--------|
| Dimensions | | see description page 13 | | |
| Pitch | [mm] | 5 / 5.08 | | |
| Hole diameter | [mm] | - | | |
| Pin dimensions | [mm]x[mm] | - | | |
| Technical data in accordance with IEC/ DIN VDE | | | | |
| Insulating material group | - | I | | |
| Surge voltage category / contamination class | -/- | III / 3 | III / 2 | II / 2 |
| Rated voltage | [V] | 250 | 320 | 630 |
| Rated surge voltage | [kV] | 4 | 4 | 4 |
| Nominal current / cross section | [A]/[mm²] | 16 / 2.5 | | |
| Maximum load current / cross section | [A]/[mm²] | 16 / 2.5 | | |
| Capacity connection | | | | |
| Solid / stranded / conductor sizes | [mm²]/[mm²]/AWG | 0.2 - 2.5 / 0.2 - 2.5 / 24 - 12 | | |
| Stranded with ferrule without / with plastic sleeve | [mm] | 0.25 - 2.5 / 0.25 - 2.5 | | |
| Multiple connection (2 conductors with same cross section) | | | | |
| Solid / stranded | [mm²] | 0.2 - 1 / 0.2 - 1.5 | | |
| Stranded with ferrule with plastic sleeve | [mm²] | 0.25 - 1 | | |
| Stranded with TWIN ferrule with plastic sleeve | [mm²] | 0.5 - 1.5 | | |
| Stripping length | [mm] | 7 | | |
| Internal cylindrical gauge (IEC 60 947-1) | | A 3 | | |
| Thread | | M 3 | | |
| Torque | [Nm] | 0.5 - 0.6 | | |
| Insulating material | | PA | | |
| Inflammability class in acc. with UL 94 | | V0 | | |

MVSTBW 2,5 HC/...-ST(-5,08) Vertical Plugs 5.0 or 5.08 mm Pitch

The designation "HC" is printed in red to provide clear identification of "high current" plugs and headers.

Only the MSTB 2,5 HC headers provided are allowed to be used for carrying the higher current load of 16 A.

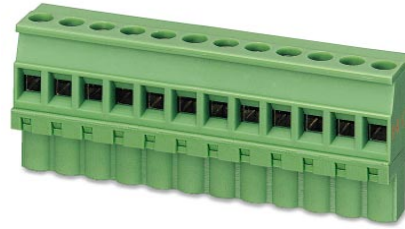

Note:

Only actuate COMBICON plug connectors when under no load condition. If for operating reasons small loads must be switched, experimental values are available upon request.

| Description | No. of pos. | Dim. a [mm] | Type | Order No. | Pcs./Pkt. |
|---|--|-------------|---|-------------------------|------------|
| COMBICON HC plugs, 5.0 mm pitch, plug-in direction vertical to the conductor axis, connection point facing the rippled wall (W) of the header, color: green | 2 | 5 | MVSTBW 2,5 HC/2-ST | 19 12 73 1 | 50 |
| | 3 | 10 | MVSTBW 2,5 HC/3-ST | 19 12 74 4 | |
| | 4 | 15 | MVSTBW 2,5 HC/4-ST | 19 12 75 7 | |
| | 5 | 20 | MVSTBW 2,5 HC/5-ST | 19 12 76 0 | |
| | 6 | 25 | MVSTBW 2,5 HC/6-ST | 19 12 77 3 | |
| | 7 | 30 | MVSTBW 2,5 HC/7-ST | 19 12 78 6 | |
| | 8 | 35 | MVSTBW 2,5 HC/8-ST | 19 12 79 9 | |
| | 9 | 40 | MVSTBW 2,5 HC/9-ST | 19 12 80 9 | |
| | 10 | 45 | MVSTBW 2,5 HC/10-ST | 19 12 81 2 | |
| | 11 | 50 | MVSTBW 2,5 HC/11-ST | 19 12 82 5 | |
| | 12 | 55 | MVSTBW 2,5 HC/12-ST | 19 12 83 8 | |
| | COMBICON HC plugs, 5.08 mm pitch, plug-in direction vertical to the conductor axis, connection point facing the rippled wall (W) of the header, color: green | 2 | 5.08 | MVSTBW 2,5 HC/2-ST-5,08 | |
| 3 | | 10.16 | MVSTBW 2,5 HC/3-ST-5,08 | 19 12 85 4 | |
| 4 | | 15.24 | MVSTBW 2,5 HC/4-ST-5,08 | 19 12 86 7 | |
| 5 | | 20.32 | MVSTBW 2,5 HC/5-ST-5,08 | 19 12 87 0 | |
| 6 | | 25.40 | MVSTBW 2,5 HC/6-ST-5,08 | 19 12 88 3 | |
| 7 | | 30.48 | MVSTBW 2,5 HC/7-ST-5,08 | 19 12 89 6 | |
| 8 | | 35.56 | MVSTBW 2,5 HC/8-ST-5,08 | 19 12 90 6 | |
| 9 | | 40.64 | MVSTBW 2,5 HC/9-ST-5,08 | 19 12 91 9 | |
| 10 | | 45.72 | MVSTBW 2,5 HC/10-ST-5,08 | 19 12 92 2 | |
| 11 | | 50.80 | MVSTBW 2,5 HC/11-ST-5,08 | 19 12 93 5 | |
| 12 | | 55.88 | MVSTBW 2,5 HC/12-ST-5,08 | 19 12 94 8 | |
| (1) Coding profile , is inserted into the groove on the plug, red insulating material | | |  | CP-MSTB | 17 34 63 4 |
| (2) Marker card , with 12 pcs. 10-section marker strips, white, self-adhesive, for 120 terminal blocks | | | SK 5/3,8 or SK 5,08/3,8 (see COMBICON catalog) | | |

Technical data

| | | | |
|---|----------------------------|---------------------------------|-------------------|
| Dimensions | see description on page 13 | | |
| Pitch | [mm] | 5 / 5.08 | |
| Hole diameter | [mm] | - | |
| Pin dimensions | [mm]x[mm] | - | |
| Technical data in accordance with IEC/ DIN VDE | | | |
| Insulating material group | - | I | |
| Surge voltage category / contamination class | -/- | III / 3 | III / 2 II / 2 |
| Rated voltage | [V] | 250 | 320 630 |
| Rated surge voltage | [kV] | 4 | 4 4 |
| Nominal current / cross section | [A]/[mm²] | 16 / 2.5 | |
| Maximum load current / cross section | [A]/[mm²] | 16 / 2.5 | |
| Capacity connection | | | |
| Solid / stranded / conductor sizes | [mm²]/[mm²]/AWG | 0.2 - 2.5 / 0.2 - 2.5 / 24 - 12 | |
| Stranded with ferrule without / with plastic sleeve | [mm²] | 0.25 - 2.5 / 0.25 - 2.5 | |
| Multiple connection (2 conductors with same cross section) | | | |
| Solid / stranded | [mm²] | 0.2 - 1 / 0.2 - 1.5 | |
| Stranded with ferrule with plastic sleeve | [mm²] | 0.25 - 1 | |
| Stranded with TWIN ferrule with plastic sleeve | [mm²] | 0.5 - 1.5 | |
| Stripping length | [mm] | 7 | |
| Internal cylindrical gauge (IEC 60 947-1) | | A 3 | |
| Thread | | M 3 | |
| Torque | [Nm] | 0.5 - 0.6 | |
| Insulating material | | PA | |
| Inflammability class in acc. with UL 94 | | V0 | |

MVSTBW 2,5 HC/...-STF(-5,08) Vertical Plugs with Screw Flange 5.0 or 5.08 mm Pitch

The designation "HC" is printed in red to provide clear identification of "high current" plugs and headers.

Only the MSTB 2,5 HC headers provided are allowed to be used for carrying the higher current load of 16 A.



Note:

Only actuate COMBICON plug connectors when under no load condition. If for operating reasons small loads must be switched, experimental values are available upon request.

| Description | No. of pos. | Dim. a [mm] | Type | Order No. | Pcs./Pkt. |
|--|---|-------------|---|--------------------------|------------|
| COMBICON HC plugs, 5.0 mm pitch, with screw flange, color: green, connection point facing the rippled wall (W) of the header | 2 | 5 | MVSTBW 2,5 HC/2-STF | 19 12 95 1 | 50 |
| | 3 | 10 | MVSTBW 2,5 HC/3-STF | 19 12 96 4 | |
| | 4 | 15 | MVSTBW 2,5 HC/4-STF | 19 12 97 7 | |
| | 5 | 20 | MVSTBW 2,5 HC/5-STF | 19 12 98 0 | |
| | 6 | 25 | MVSTBW 2,5 HC/6-STF | 19 12 99 3 | |
| | 7 | 30 | MVSTBW 2,5 HC/7-STF | 19 13 00 2 | |
| | 8 | 35 | MVSTBW 2,5 HC/8-STF | 19 13 01 5 | |
| | 9 | 40 | MVSTBW 2,5 HC/9-STF | 19 13 02 8 | |
| | 10 | 45 | MVSTBW 2,5 HC/10-STF | 19 13 03 1 | |
| | 11 | 50 | MVSTBW 2,5 HC/11-STF | 19 13 04 4 | |
| | 12 | 55 | MVSTBW 2,5 HC/12-STF | 19 13 05 7 | |
| | COMBICON HC plugs, 5.08 mm pitch, with screw flange, color: green, connection point facing the rippled wall (W) of the header | 2 | 5.08 | MVSTBW 2,5 HC/2-STF-5,08 | |
| 3 | | 10.16 | MVSTBW 2,5 HC/3-STF-5,08 | 19 13 07 3 | |
| 4 | | 15.24 | MVSTBW 2,5 HC/4-STF-5,08 | 19 13 08 6 | |
| 5 | | 20.32 | MVSTBW 2,5 HC/5-STF-5,08 | 19 13 09 9 | |
| 6 | | 25.40 | MVSTBW 2,5 HC/6-STF-5,08 | 19 13 10 9 | |
| 7 | | 30.48 | MVSTBW 2,5 HC/7-STF-5,08 | 19 13 11 2 | |
| 8 | | 35.56 | MVSTBW 2,5 HC/8-STF-5,08 | 19 13 12 5 | |
| 9 | | 40.64 | MVSTBW 2,5 HC/9-STF-5,08 | 19 13 13 8 | |
| 10 | | 45.72 | MVSTBW 2,5 HC/10-STF-5,08 | 19 13 14 1 | |
| 11 | | 50.80 | MVSTBW 2,5 HC/11-STF-5,08 | 19 13 15 4 | |
| 12 | | 55.88 | MVSTBW 2,5 HC/12-STF-5,08 | 19 13 16 7 | |
| (1) Coding profile , is inserted into the groove on the plug, red insulating material | | |  | CP-MSTB | 17 34 63 4 |
| (2) Marker card , with 12 pcs. 10-section marker strips, white, self-adhesive, for 120 terminal blocks | | | SK 5/3,8 or SK 5,08/3,8 (see COMBICON catalog) | | |

Technical data

| | | | |
|---|---|---------------------------------|----------------|
| Dimensions | see description on page 13 | | |
| Pitch | [mm] | 5 / 5.08 | |
| Hole diameter | [mm] | - | |
| Pin dimensions | [mm]x[mm] | - | |
| Technical data in accordance with IEC/ DIN VDE | | | |
| Insulating material group | - | I | |
| Surge voltage category / contamination class | -/- | III / 3 | III / 2 II / 2 |
| Rated voltage | [V] | 250 | 320 630 |
| Rated surge voltage | [kV] | 4 | 4 4 |
| Nominal current / cross section | [A]/[mm ²] | 16 / 2.5 | |
| Maximum load current / cross section | [A]/[mm ²] | 16 / 2.5 | |
| Capacity connection | | | |
| Solid / stranded / conductor sizes | [mm ²]/[mm ²]/AWG | 0.2 - 2.5 / 0.2 - 2.5 / 24 - 12 | |
| Stranded with ferrule without / with plastic sleeve | [mm ²] | 0.25 - 2.5 / 0.25 - 2.5 | |
| Multiple connection (2 conductors with same cross section) | | | |
| Solid / stranded | [mm ²] | 0.2 - 1 / 0.2 - 1.5 | |
| Stranded with ferrule with plastic sleeve | [mm ²] | 0.25 - 1 | |
| Stranded with TWIN ferrule with plastic sleeve | [mm ²] | 0.5 - 1.5 | |
| Stripping length | [mm] | 7 | |
| Internal cylindrical gauge (IEC 60 947-1) | | A 3 | |
| Thread | | M 3 | |
| Torque | [Nm] | 0.5 - 0.6 | |
| Insulating material | | PA | |
| Inflammability class in acc. with UL 94 | | V0 | |

MSTBA 2,5 HC/...-G(-5,08) 5.0 or 5.08 mm Pitch

The designation "HC" is printed in red to provide clear identification of "high current" plugs and headers.

Only the MSTB 2,5 HC headers provided are allowed to be used for carrying the higher current load of 16 A.

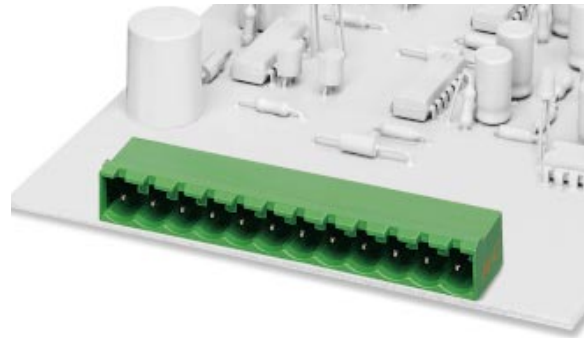

Note:

Only actuate COMBICON plug connectors when under no load condition. If for operating reasons small loads must be switched, experimental values are available upon request.

| Description | No. of pos. | Dim. a [mm] | Type | Order No. | Pcs./Pkt. |
|---|------------------------|---|--|------------|-----------|
| COMBICON HC headers, 5.0 mm pitch, plug-in direction parallel to the p.c.b., color: green | | | | | |
| | 2 | 5 | MSTBA 2,5 HC/2-G | 19 23 75 9 | 50 |
| | 3 | 10 | MSTBA 2,5 HC/3-G | 19 23 76 2 | |
| | 4 | 15 | MSTBA 2,5 HC/4-G | 19 23 77 5 | |
| | 5 | 20 | MSTBA 2,5 HC/5-G | 19 23 78 8 | |
| | 6 | 25 | MSTBA 2,5 HC/6-G | 19 23 79 1 | |
| | 7 | 30 | MSTBA 2,5 HC/7-G | 19 23 80 1 | |
| | 8 | 35 | MSTBA 2,5 HC/8-G | 19 23 81 4 | |
| | 9 | 40 | MSTBA 2,5 HC/9-G | 19 23 82 7 | |
| | 10 | 45 | MSTBA 2,5 HC/10-G | 19 23 83 0 | |
| | 11 | 50 | MSTBA 2,5 HC/11-G | 19 23 84 3 | |
| | 12 | 55 | MSTBA 2,5 HC/12-G | 19 23 85 6 | |
| COMBICON HC headers, 5.08 mm pitch, plug-in direction parallel to the p.c.b., color: green | | | | | |
| | 2 | 5.08 | MSTBA 2,5 HC/2-G-5,08 | 19 23 86 9 | 50 |
| | 3 | 10.16 | MSTBA 2,5 HC/3-G-5,08 | 19 23 87 2 | |
| | 4 | 15.24 | MSTBA 2,5 HC/4-G-5,08 | 19 23 88 5 | |
| | 5 | 20.32 | MSTBA 2,5 HC/5-G-5,08 | 19 23 89 8 | |
| | 6 | 25.40 | MSTBA 2,5 HC/6-G-5,08 | 19 23 90 8 | |
| | 7 | 30.48 | MSTBA 2,5 HC/7-G-5,08 | 19 23 91 1 | |
| | 8 | 35.56 | MSTBA 2,5 HC/8-G-5,08 | 19 23 92 4 | |
| | 9 | 40.64 | MSTBA 2,5 HC/9-G-5,08 | 19 23 93 7 | |
| | 10 | 45.72 | MSTBA 2,5 HC/10-G-5,08 | 19 23 94 0 | |
| | 11 | 50.80 | MSTBA 2,5 HC/11-G-5,08 | 19 12 95 3 | |
| | 12 | 55.88 | MSTBA 2,5 HC/12-G-5,08 | 19 12 96 6 | |
| (1) Coding section , inserted into the recess in the header, red insulating material | |  | CR-MSTB | 17 34 40 1 | |
| (2) Marker card , with 12 pcs. 10-section marker strips, white, self-adhesive, for 120 terminal blocks | | | SK 5/3,8 or SK 5,08/3,8 (see COMBICON catalog) | | |
| Technical data | | | see description | | |
| Dimensions | | | 5 / 5.08 | | |
| Pitch | [mm] | | 1.4 | | |
| Hole diameter | [mm] | | 1 x 1 | | |
| Pin dimensions | [mm]x[mm] | | | | |
| Technical data in accordance with IEC/ DIN VDE | | | | | |
| Insulating material group | - | | IIIa | II / 2 | |
| Surge voltage category / contamination class | -/- | | III / 3 | III / 2 | II / 2 |
| Rated voltage | [V] | | 250 | 320 | 400 |
| Rated surge voltage | [kV] | | 4 | 4 | 4 |
| Nominal current / cross section | [A]/[mm ²] | | 16 / - | | |
| Maximum load current / cross section | [A]/[mm ²] | | 16 / - | | |
| Insulating material | | | PBT | | |
| Inflammability class in acc. with UL 94 | | | V0 | | |

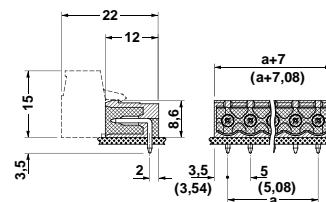
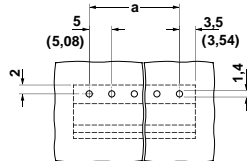

MSTBVA 2,5 HC/...-G(-5,08) 5.0 or 5.08 mm Pitch

The designation "HC" is printed in red to provide clear identification of "high current" plugs and headers.

Only the MSTB 2,5 HC headers provided are allowed to be used for carrying the higher current load of 16 A.

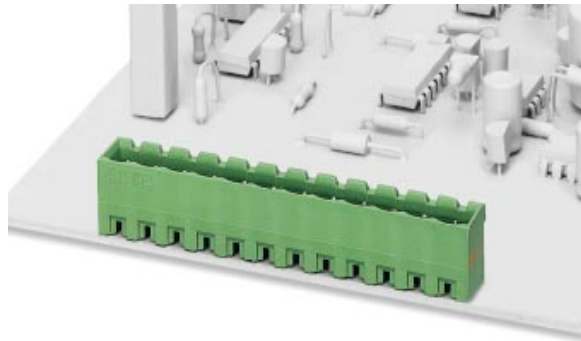

Note:

Only actuate COMBICON plug connectors when under no load condition. If for operating reasons small loads must be switched, experimental values are available upon request.

| Description | No. of pos. | Dim. a [mm] | Type | Order No. | Pcs./Pkt. |
|---|-------------|---|--|-------------------|-----------|
| COMBICON HC headers vertical, 5.0 mm pitch, color: green, plug-in direction vertical to the p.c.b. | | | | | |
| | 2 | 5 | MSTBVA 2,5 HC/2-G | 19 24 19 8 | 50 |
| | 3 | 10 | MSTBVA 2,5 HC/3-G | 19 24 20 8 | |
| | 4 | 15 | MSTBVA 2,5 HC/4-G | 19 24 21 1 | |
| | 5 | 20 | MSTBVA 2,5 HC/5-G | 19 24 22 4 | |
| | 6 | 25 | MSTBVA 2,5 HC/6-G | 19 24 23 7 | |
| | 7 | 30 | MSTBVA 2,5 HC/7-G | 19 24 24 0 | |
| | 8 | 35 | MSTBVA 2,5 HC/8-G | 19 24 25 3 | |
| | 9 | 40 | MSTBVA 2,5 HC/9-G | 19 24 26 6 | |
| | 10 | 45 | MSTBVA 2,5 HC/10-G | 19 24 27 9 | |
| | 11 | 50 | MSTBVA 2,5 HC/11-G | 19 24 28 2 | |
| | 12 | 55 | MSTBVA 2,5 HC/12-G | 19 24 29 5 | |
| COMBICON HC headers vertical, 5.08 mm pitch, color: green, plug-in direction vertical to the p.c.b. | | | | | |
| | 2 | 5.08 | MSTBVA 2,5 HC/2-G-5,08 | 19 24 30 5 | 50 |
| | 3 | 10.16 | MSTBVA 2,5 HC/3-G-5,08 | 19 24 31 8 | |
| | 4 | 15.24 | MSTBVA 2,5 HC/4-G-5,08 | 19 24 32 1 | |
| | 5 | 20.32 | MSTBVA 2,5 HC/5-G-5,08 | 19 24 33 4 | |
| | 6 | 25.40 | MSTBVA 2,5 HC/6-G-5,08 | 19 24 34 7 | |
| | 7 | 30.48 | MSTBVA 2,5 HC/7-G-5,08 | 19 24 35 0 | |
| | 8 | 35.56 | MSTBVA 2,5 HC/8-G-5,08 | 19 24 36 3 | |
| | 9 | 40.64 | MSTBVA 2,5 HC/9-G-5,08 | 19 24 37 6 | |
| | 10 | 45.72 | MSTBVA 2,5 HC/10-G-5,08 | 19 24 38 9 | |
| | 11 | 50.80 | MSTBVA 2,5 HC/11-G-5,08 | 19 24 39 2 | |
| | 12 | 55.88 | MSTBVA 2,5 HC/12-G-5,08 | 19 24 40 2 | |
| (1) Coding section , inserted into the recess in the header, red insulating material | |  | CR-MSTB | 17 34 40 1 | |
| (2) Marker card , with 12 pcs. 10-section marker strips, white, self-adhesive, for 120 terminal blocks | | | SK 5/3,8 or SK 5,08/3,8 (see COMBICON catalog) | | |

Technical data

| | | | | |
|---|-----------|-----------------|---------|--------|
| Dimensions | | see description | | |
| Pitch | [mm] | 5 / 5.08 | | |
| Hole diameter | [mm] | 1.4 | | |
| Pin dimensions | [mm]x[mm] | 1 x 1 | | |
| Technical data in accordance with IEC/ DIN VDE | | | | |
| Insulating material group | - | I | | |
| Surge voltage category / contamination class | -/- | III / 3 | III / 2 | II / 2 |
| Rated voltage | [V] | 250 | 320 | 400 |
| Rated surge voltage | [kV] | 4 | 4 | 4 |
| Nominal current / cross section | [A]/[mm²] | 16 / - | | |
| Maximum load current / cross section | [A]/[mm²] | 16 / - | | |
| Insulating material | | PA | | |
| Inflammability class in acc. with UL 94 | | V0 | | |

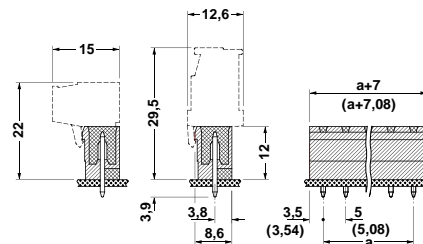
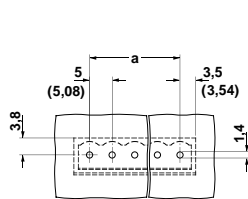

MSTB 2,5 HC/...-GF(-5,08) with Screw Flange 5.0 or 5.08 mm Pitch

The designation "HC" is printed in red to provide clear identification of "high current" plugs and headers.

Only the MSTB 2,5 HC headers provided are allowed to be used for carrying the higher current load of 16 A.

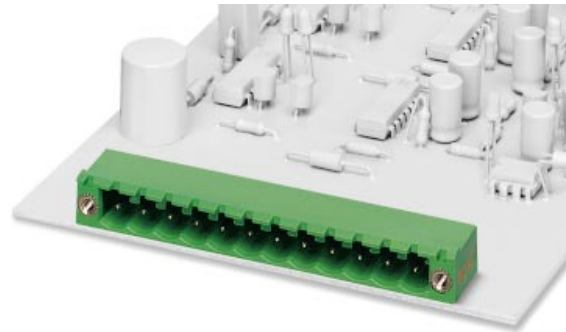

Note:

Only actuate COMBICON plug connectors when under no load condition. If for operating reasons small loads must be switched, experimental values are available upon request.

| Description | No. of pos. | Dim. a [mm] | Type | Order No. | Pcs./Pkt. |
|---|-------------|---|--|------------|-----------|
| COMBICON HC headers, | | | | | |
| 5.0 mm pitch, color: green, with threaded flange, plug-in direction parallel to the p.c.b. | | | | | |
| | 2 | 5 | MSTB 2,5 HC/2-GF | 19 23 97 9 | 50 |
| | 3 | 10 | MSTB 2,5 HC/3-GF | 19 23 98 2 | |
| | 4 | 15 | MSTB 2,5 HC/4-GF | 19 23 99 5 | |
| | 5 | 20 | MSTB 2,5 HC/5-GF | 19 24 00 4 | |
| | 6 | 25 | MSTB 2,5 HC/6-GF | 19 24 01 7 | |
| | 7 | 30 | MSTB 2,5 HC/7-GF | 19 24 02 0 | |
| | 8 | 35 | MSTB 2,5 HC/8-GF | 19 24 03 3 | |
| | 9 | 40 | MSTB 2,5 HC/9-GF | 19 24 04 6 | |
| | 10 | 45 | MSTB 2,5 HC/10-GF | 19 24 05 9 | |
| | 11 | 50 | MSTB 2,5 HC/11-GF | 19 24 06 2 | |
| | 12 | 55 | MSTB 2,5 HC/12-GF | 19 24 07 5 | |
| COMBICON HC headers, | | | | | |
| 5.08 mm pitch, color: green, with threaded flange, plug-in direction parallel to the p.c.b. | | | | | |
| | 2 | 5.08 | MSTB 2,5 HC/2-GF-5,08 | 19 24 08 8 | 50 |
| | 3 | 10.16 | MSTB 2,5 HC/3-GF-5,08 | 19 24 09 1 | |
| | 4 | 15.24 | MSTB 2,5 HC/4-GF-5,08 | 19 24 10 1 | |
| | 5 | 20.32 | MSTB 2,5 HC/5-GF-5,08 | 19 24 11 4 | |
| | 6 | 25.40 | MSTB 2,5 HC/6-GF-5,08 | 19 24 12 7 | |
| | 7 | 30.48 | MSTB 2,5 HC/7-GF-5,08 | 19 24 13 0 | |
| | 8 | 35.56 | MSTB 2,5 HC/8-GF-5,08 | 19 24 14 3 | |
| | 9 | 40.64 | MSTB 2,5 HC/9-GF-5,08 | 19 24 15 6 | |
| | 10 | 45.72 | MSTB 2,5 HC/10-GF-5,08 | 19 24 16 9 | |
| | 11 | 50.80 | MSTB 2,5 HC/11-GF-5,08 | 19 24 17 2 | |
| | 12 | 55.88 | MSTB 2,5 HC/12-GF-5,08 | 19 24 18 5 | |
| (1) Coding section , inserted into the recess in the header, red insulating material | |  | CR-MSTB | 17 34 40 1 | |
| (2) Marker card , with 12 pcs. 10-section marker strips, white, self-adhesive, for 120 terminal blocks | | | SK 5/3,8 or SK 5,08/3,8 (see COMBICON catalog) | | |

Technical data

| | | | | |
|---|------------------------|-----------------|---------|--------|
| Dimensions | | see description | | |
| Pitch | [mm] | 5 / 5.08 | | |
| Hole diameter | [mm] | 1.4 | | |
| Pin dimensions | [mm]x[mm] | 1 x 1 | | |
| Technical data in accordance with IEC/ DIN VDE | | | | |
| Insulating material group | - | IIIa | | |
| Surge voltage category / contamination class | -/- | III / 3 | III / 2 | II / 2 |
| Rated voltage | [V] | 250 | 320 | 400 |
| Rated surge voltage | [kV] | 4 | 4 | 4 |
| Nominal current / cross section | [A]/[mm ²] | 16 / - | | |
| Maximum load current / cross section | [A]/[mm ²] | 16 / - | | |
| Insulating material | | PBT | | |
| Inflammability class in acc. with UL 94 | | V0 | | |

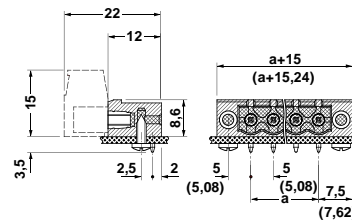
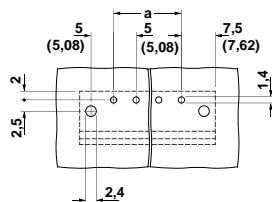

MSTBV 2,5 HC/...-GF(-5,08) with Screw Flange 5.0 or 5.08 mm Pitch

The designation "HC" is printed in red to provide clear identification of "high current" plugs and headers.

Only the MSTB 2,5 HC headers provided are allowed to be used for carrying the higher current load of 16 A.

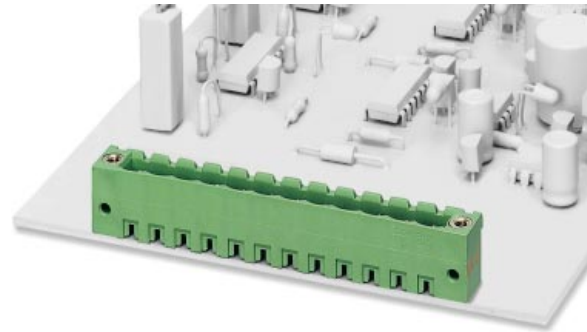

Note:

Only actuate COMBICON plug connectors when under no load condition. If for operating reasons small loads must be switched, experimental values are available upon request.

| Description | No. of pos. | Dim. a [mm] | Type | Order No. | Pcs./Pkt. |
|--|-------------|---|--|------------|-----------|
| COMBICON HC headers vertical, 5.0 mm pitch, color: green, with threaded flange, plug-in direction vertical to the p.c.b. | | | | | |
| | 2 | 5 | MSTBV 2,5 HC/2-GF | 19 24 41 5 | 50 |
| | 3 | 10 | MSTBV 2,5 HC/3-GF | 19 24 42 8 | |
| | 4 | 15 | MSTBV 2,5 HC/4-GF | 19 24 43 1 | |
| | 5 | 20 | MSTBV 2,5 HC/5-GF | 19 24 44 4 | |
| | 6 | 25 | MSTBV 2,5 HC/6-GF | 19 24 45 7 | |
| | 7 | 30 | MSTBV 2,5 HC/7-GF | 19 24 46 0 | |
| | 8 | 35 | MSTBV 2,5 HC/8-GF | 19 24 47 3 | |
| | 9 | 40 | MSTBV 2,5 HC/9-GF | 19 24 48 6 | |
| | 10 | 45 | MSTBV 2,5 HC/10-GF | 19 24 49 9 | |
| | 11 | 50 | MSTBV 2,5 HC/11-GF | 19 24 50 9 | |
| | 12 | 55 | MSTBV 2,5 HC/12-GF | 19 24 51 2 | |
| COMBICON HC headers vertical, 5.08 mm pitch, color: green, with threaded flange, plug-in direction vertical to the p.c.b. | | | | | |
| | 2 | 5.08 | MSTBV 2,5 HC/2-GF-5,08 | 19 24 52 5 | 50 |
| | 3 | 10.16 | MSTBV 2,5 HC/3-GF-5,08 | 19 24 53 8 | |
| | 4 | 15.24 | MSTBV 2,5 HC/4-GF-5,08 | 19 24 54 1 | |
| | 5 | 20.32 | MSTBV 2,5 HC/5-GF-5,08 | 19 24 55 4 | |
| | 6 | 25.40 | MSTBV 2,5 HC/6-GF-5,08 | 19 24 56 7 | |
| | 7 | 30.48 | MSTBV 2,5 HC/7-GF-5,08 | 19 24 57 0 | |
| | 8 | 35.56 | MSTBV 2,5 HC/8-GF-5,08 | 19 24 58 3 | |
| | 9 | 40.64 | MSTBV 2,5 HC/9-GF-5,08 | 19 24 59 6 | |
| | 10 | 45.72 | MSTBV 2,5 HC/10-GF-5,08 | 19 24 60 6 | |
| | 11 | 50.80 | MSTBV 2,5 HC/11-GF-5,08 | 19 24 61 9 | |
| | 12 | 55.88 | MSTBV 2,5 HC/12-GF-5,08 | 19 24 62 2 | |
| (1) Coding section , inserted into the recess in the header, red insulating material | |  | CR-MSTB | 17 34 40 1 | |
| (2) Marker card , with 12 pcs. 10-section marker strips, white, self-adhesive, for 120 terminal blocks | | | SK 5/3,8 or SK 5,08/3,8 (see COMBICON catalog) | | |

Technical data

| | | | | |
|---|------------------------|-----------------|---------|--------|
| Dimensions | | see description | | |
| Pitch | [mm] | 5 / 5.08 | | |
| Hole diameter | [mm] | 1.4 | | |
| Pin dimensions | [mm]x[mm] | 1 x 1 | | |
| Technical data in accordance with IEC/ DIN VDE | | | | |
| Insulating material group | - | I | | |
| Surge voltage category / contamination class | -/- | III / 3 | III / 2 | II / 2 |
| Rated voltage | [V] | 250 | 320 | 400 |
| Rated surge voltage | [kV] | 4 | 4 | 4 |
| Nominal current / cross section | [A]/[mm ²] | 16 / - | | |
| Maximum load current / cross section | [A]/[mm ²] | 16 / - | | |
| Insulating material | | PA | | |
| Inflammability class in acc. with UL 94 | | V0 | | |

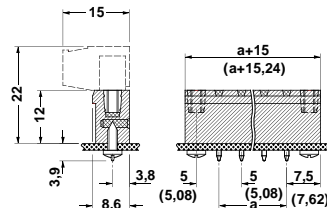
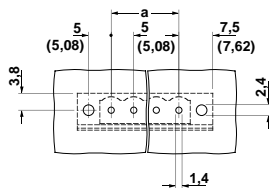

Descriptions

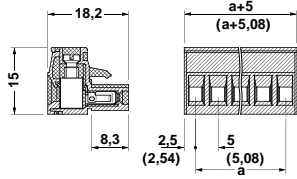

MSTB 2,5 HC/...-ST(-5,08)

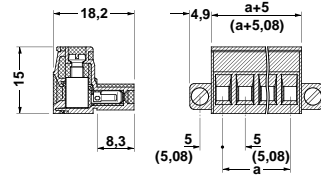

MSTB 2,5 HC/...-STF(-5,08)

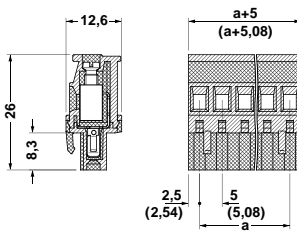

MVSTBR 2,5 HC/...-ST(-5,08)

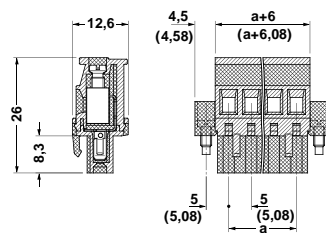

MVSTBR 2,5 HC/...-STF(-5,08)

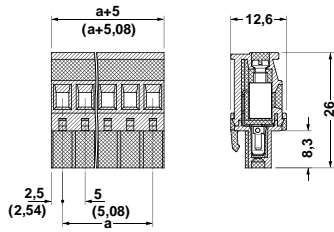

MVSTBW 2,5 HC/...-STF(-5,08)

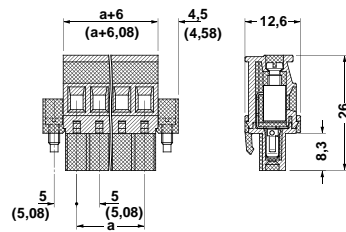

MVSTBW 2,5 HC/...-STF(-5,08)

О компании

ООО "ТрейдЭлектроникс" - это оперативные поставки широкого спектра электронных компонентов отечественного и импортного производства напрямую от производителей и с крупнейших мировых складов. Реализуемая нашей компанией продукция насчитывает более полумиллиона наименований.

Благодаря этому наша компания предлагает к поставке практически не ограниченный ассортимент компонентов как оптовыми, мелкооптовыми партиями, так и в розницу.

Наличие собственной эффективной системы логистики обеспечивает надежную поставку продукции по конкурентным ценам в точно указанные сроки.

Срок поставки со стоков в **Европе и Америке – от 3 до 14 дней.**

Срок поставки из **Азии – от 10 дней.**

Благодаря развитой сети поставщиков, помогаем в поиске и приобретении экзотичных или снятых с производства компонентов.

Предоставляем спец цены на элементы для создания инженерных сэмплов.

Упорный труд, качественный результат дают нам право быть уверенными в себе и надежными для наших клиентов.

Наша компания это:

- Гарантия качества поставляемой продукции
- Широкий ассортимент
- Минимальные сроки поставок
- Техническая поддержка
- Подбор комплектации
- Индивидуальный подход
- Гибкое ценообразование

Наша организация особенно сильна в поставках модулей, микросхем, пассивных компонентов, ксайленсах (XC), EPF, EPM и силовой электроники.

Большой выбор предлагаемой продукции, различные виды оплаты и доставки, позволят Вам сэкономить время и получить максимум выгоды от сотрудничества с нами!

Перечень производителей, продукцию которых мы поставляем на российский рынок



С удовольствием будем прорабатывать для Вас поставки всех необходимых компонентов по текущим запросам для скорейшего выявления групп элементов, по которым сотрудничество именно с нашей компанией будет для Вас максимально выгодным!

С уважением,

Менеджер отдела продаж ООО

«Трейд Электроникс»

Шишлаков Евгений

8 (495)668-30-28 доб 169

manager28@tradeelectronics.ru

<http://www.tradeelectronics.ru/>